

Lateral "J" Patella Stabilizer

Warnings and Instructions: Review carefully, proper application is required

⚠ Warning: This device will not prevent or eliminate risk of injury. Do Not Over-tighten. If swelling, pain, skin irritation, or an unusual reaction occurs, discontinue use immediately and consult your medical professional. This device should not be worn by persons with known allergies to neoprene.

Care: Hand wash using mild soap. Rinse thoroughly. Air dry only. Do not tumble dry.

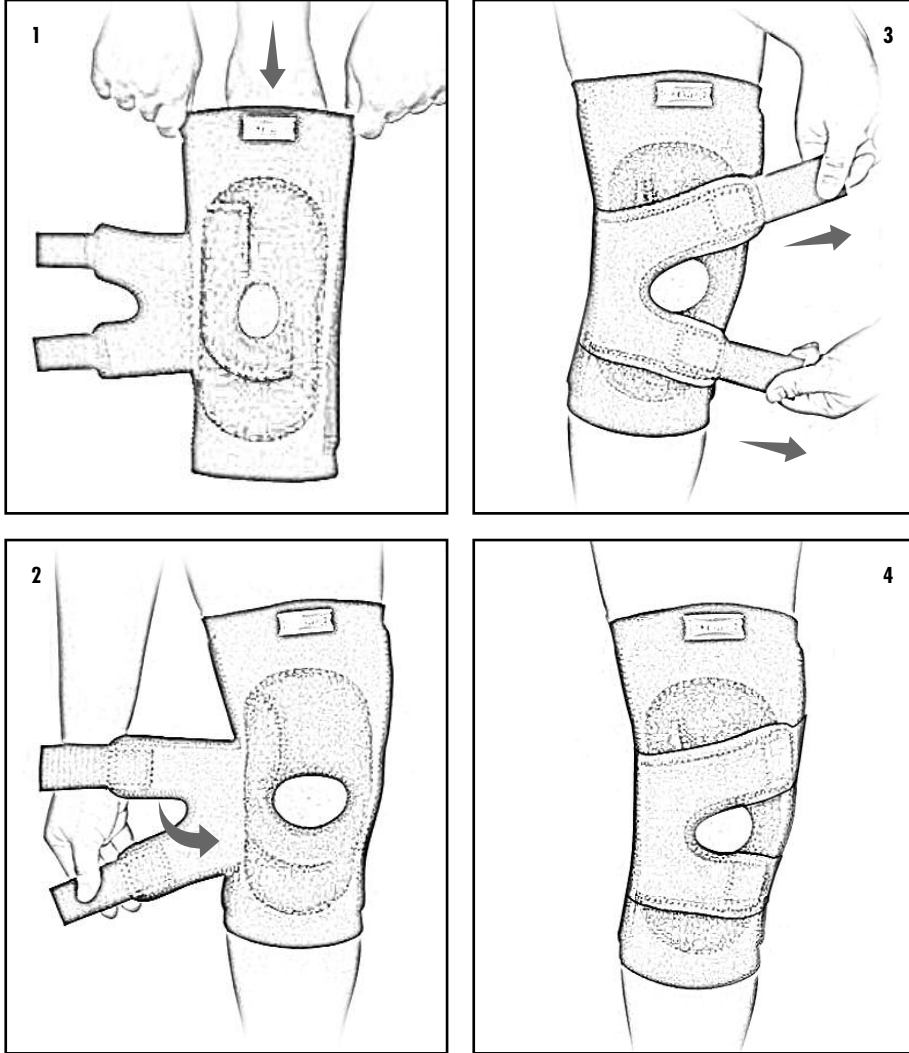

CE

EC REP

MDSS GmbH, Schiffgraben 41
30175 Hannover, Germany

Rev A 2/09

HELY & WEBER

1185 East Main St., Santa Paula, California 93060
California: 800-221-5465, National: 800-654-3241
International: 805-525-4244, fax: 805-933-2348
U.S. fax: 800-559-5975, www.hely-weber.com

© 2009 Weber Orthopedic Inc.
DBA Hely & Weber All rights reserved.

Lateral "J" Patella Stabilizer

Warnings and Instructions: Review carefully, proper application is required

⚠ Warning: This device will not prevent or eliminate risk of injury. Do Not Over-tighten. If swelling, pain, skin irritation, or an unusual reaction occurs, discontinue use immediately and consult your medical professional. This device should not be worn by persons with known allergies to neoprene.

Care: Hand wash using mild soap. Rinse thoroughly. Air dry only. Do not tumble dry.

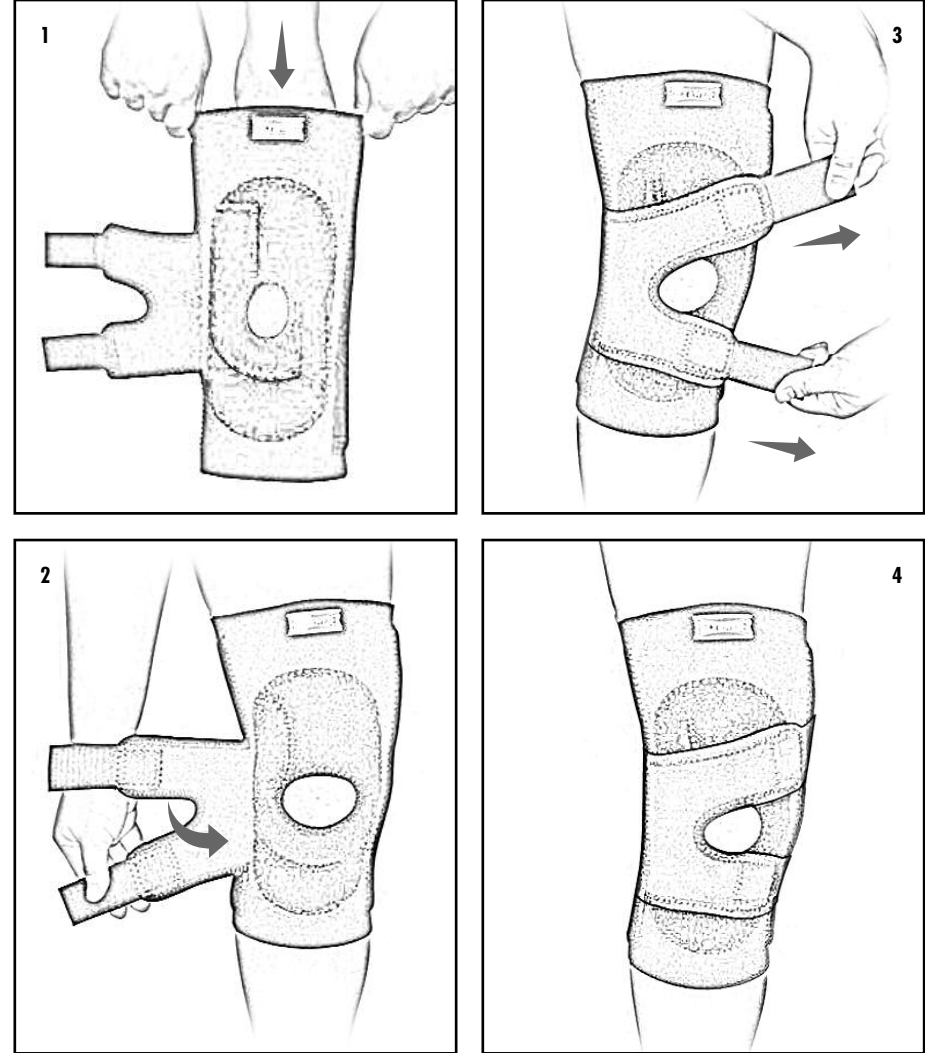

CE

EC REP

MDSS GmbH, Schiffgraben 41
30175 Hannover, Germany

Rev A 2/09

HELY & WEBER

1185 East Main St., Santa Paula, California 93060
California: 800-221-5465, National: 800-654-3241
International: 805-525-4244, fax: 805-933-2348
U.S. fax: 800-559-5975, www.hely-weber.com

© 2009 Weber Orthopedic Inc.
DBA Hely & Weber All rights reserved.