

Congratulations on purchasing MedCline!

You are one step closer to finally enjoying a good night's sleep. Whether you purchased MedCline for nighttime acid reflux, shoulder pain, or another ailment, quality sleep plays a vital role in good health, physical and mental well-being, and quality of life. We certainly hope that MedCline brings the relief that you are seeking, as it has for thousands of other satisfied MedCline customers.

Please read through this Comfort Guide to learn how to set up your MedCline, as well as for comfort tips to help you adjust to the new sleep position for maximum comfort and relief.



If you have questions about your MedCline, please call
1-858-605-1747 (US).

Box Includes:

1. Body Pillow
2. Incline Wedge
3. Insert Pillow
4. Comfort Guide

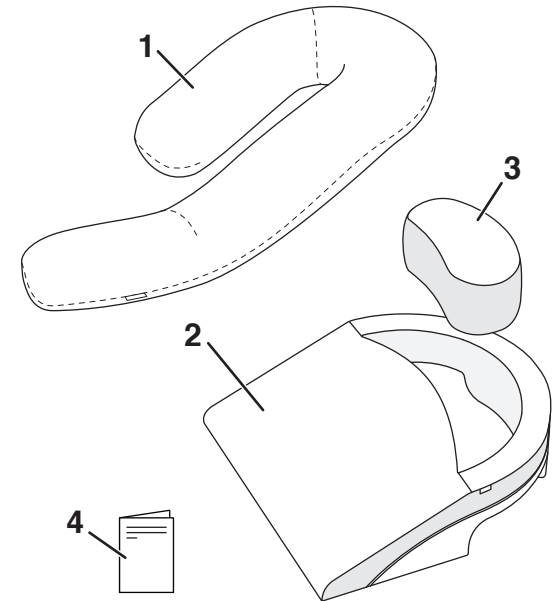

NOTE: Foam components have been compressed for shipment. Please allow up to 24 hours after opening for full shape recovery and for natural, new foam smell to dissipate.

www.medcline.com



Manufacturer:
AMENITY HEALTH, INC.
8825 Rehco Road Suite D.
San Diego, California 92121 U.S.A.



EC REP

EMERGO EUROPE
Prinsessegracht 20
2514 AP The Hague
The Netherlands

Australian Sponsor:
EMERGO AUSTRALIA
Level 20, Tower II
Darling Park 201 Sussex Street
Sydney, NSW 2000 Australia

Setup and Assembly

- 1 Place the Incline Wedge on either side of the bed, as illustrated below.

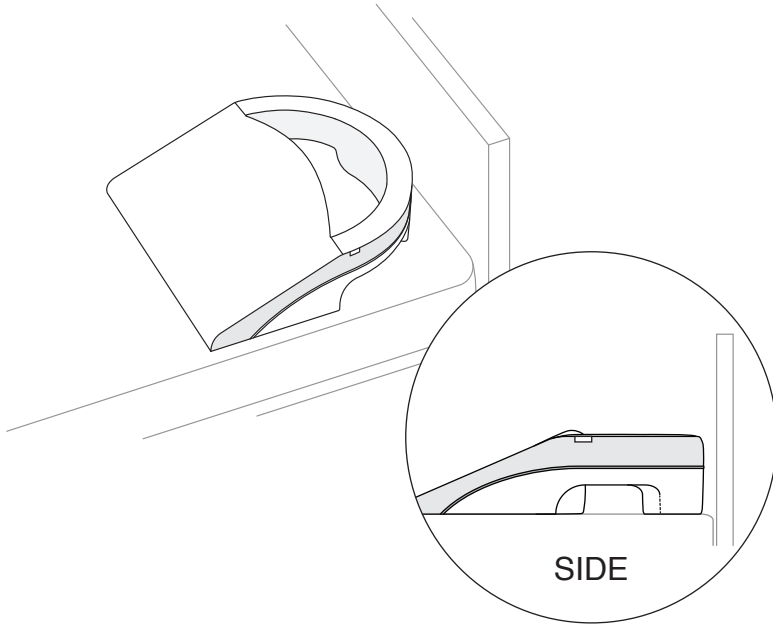

- 2 Place the Insert Pillow into the inner cavity of the Incline Wedge. (Compressed Insert Pillow will require shaking and re-fluffing to regain shape.)

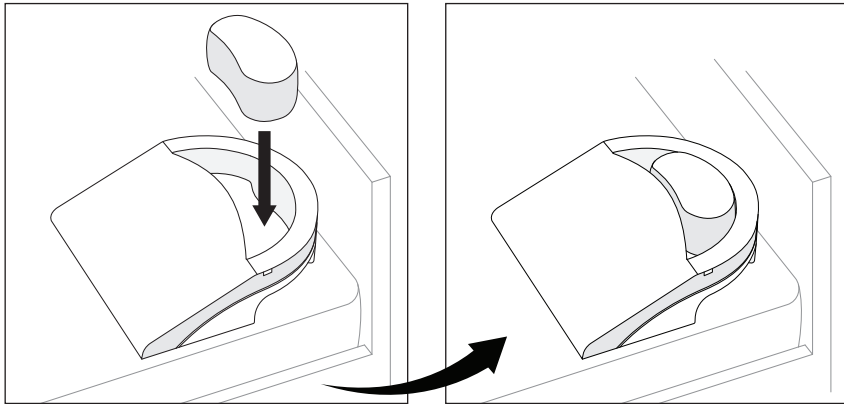

If you did not purchase this Amenity Health MedCline™ directly from Amenity Health, proof of purchase will be required to demonstrate that you are the original purchaser and eligible to make a valid claim under this Warranty. If original proof of purchase is not provided by the Purchaser, Amenity Health reserves the right to determine if the unit is covered, or is not covered, by this warranty and may use the manufacturing date as the warranty commencement date.

The decision to repair or to replace defective parts under this Limited Warranty shall be made by Amenity Health at its option and at its sole discretion. There is no warranty at all after one year, dating from commencement of this Limited Warranty.

AMENITY HEALTH SHALL NOT BE LIABLE FOR INCIDENTAL OR CONSEQUENTIAL DAMAGES RESULTING FROM THE USE OF THIS PRODUCT OR ARISING OUT OF ANY BREACH OF THIS WARRANTY. THE EXCLUSIVE REMEDY FOR BREACH OF THIS WARRANTY SHALL BE REPLACEMENT OR CREDIT TOWARDS REPLACEMENT AS SET FORTH HEREIN. THERE ARE NO EXPRESS OR IMPLIED WARRANTIES, INCLUDING IMPLIED WARRANTIES OF MERCHANTABILITY AND FITNESS FOR A PARTICULAR PURPOSE, OTHER THAN THE WARRANTY DESCRIBED ON THE FACE OF THIS LIMITED WARRANTY.

Some states do not allow the exclusion or limitation of incidental or consequential damages, so the above limitation or exclusion may not apply to every purchaser. This warranty gives the purchaser specific legal rights, and the purchaser may also have other legal rights, which may vary from state to state. This warranty is valid in all 50 states, Puerto Rico and Canada. If you, the Purchaser, experience any problem with your MedCline™ during the warranty period, please contact Amenity Health's Customer Service Department by calling 1-858-605-1747 or by sending an email to info@amenityhealth.com.

Warranty Information

Limited Warranty for MedCline™ Reflux Relief System

AMENITY HEALTH INC (“AMENITY HEALTH”) WARRANTS THAT IT WILL, AT AMENITY HEALTH’S OPTION, REPLACE OR REPAIR PURCHASER’S MEDCLINE™ DEVICE IF IT IS DEFECTIVE DUE TO FAULTY WORKMANSHIP OR MATERIALS, SUBJECT TO THE LIMITATIONS DESCRIBED IN THIS WARRANTY. AMENITY HEALTH UNDERTAKES NO RESPONSIBILITY FOR THE QUALITY OF THE GOODS EXCEPT AS OTHERWISE PROVIDED IN THIS CONTRACT. THERE ARE NO WARRANTIES THAT EXTEND BEYOND THE DESCRIPTION ON THE FACE THEREOF.

1 YEAR: FULL COVERAGE OF PARTS AND LABOR

MedCline™ is warranted against defects in the workmanship or materials for a period of one (1) year from the warranty commencement date. Upon notice during the first year from the warranty commencement date, Amenity Health will send replacement parts to the Purchaser, at no cost, in order to replace any such defective part. In addition, Amenity Health will pay all authorized labor and transportation costs associated with the repair or replacement of any parts which Amenity Health determines to be defective. This one (1) year warranty shall not apply if the purchaser does not return any and all defective parts to Amenity Health within 15 days of Purchaser’s receipt of such replacement parts furnished.

In no instance will this warranty cover any damage attributable to misuse or to normal wear and tear or to excessive weight placed upon the product. Nor will this warranty cover any purchaser other than the original purchaser nor will it cover product purchased from an unauthorized third party. If you are not the original purchaser of this product, you take “as is” and “with all faults.” If you did not purchase this Amenity Health MedCline™ directly from Amenity Health we will require proof of purchase from you demonstrating that you are the original purchaser and are eligible to make a valid claim under this Warranty.

ADDITIONAL TERMS AND CONDITIONS

This warranty does not include coverage for damage caused by the Purchasers or by other users if the product has been used in a manner inconsistent with the operation and maintenance procedures outlined in the Instructions for Use, this Warranty, or any other applicable document published or approved by Amenity Health. Nor does it include coverage if the product has been repaired or modified by the Purchaser or by an unauthorized third party or if the product has been damaged in transit. If the recommended weight restrictions are not followed, this warranty is void. Replacement parts may be new or reconditioned at Amenity Health’s discretion. There is no warranty at all after one year, dating from commencement of this Limited Warranty.

ADDITIONAL LIMITATIONS ON WARRANTY COVERAGE

In the event a warranty claim is filed and a warranty replacement is deemed necessary, purchaser will be required to surrender the original product, including any components, to Amenity Health at the time of the replacement. Repairs to or replacement of the Amenity Health MedCline™ or its components under the terms of this Limited Warranty will apply to the original warranty period and will not serve to extend such period. This warranty begins on the “warranty commencement date” which is the date of purchase for new unused products.

3 Place the Body Pillow on top and in the center of the Incline Wedge, as shown.

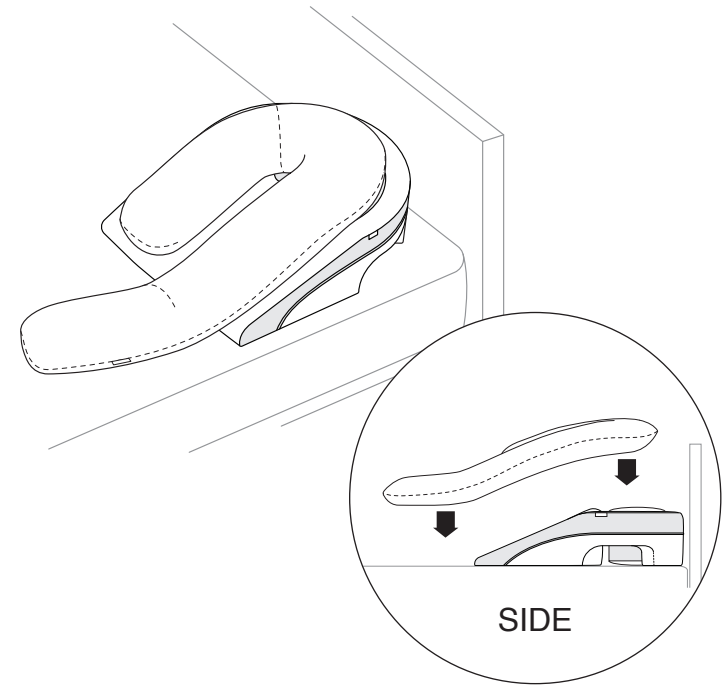

NOTE: MedCline can also be used with a variety of pillow types. Some users find that using their own, familiar pillow is a good alternative as they are getting used to the new sleep position.



Proper Positioning

- 1** Insert your downside arm into the space between the Insert Pillow and the Incline Wedge.

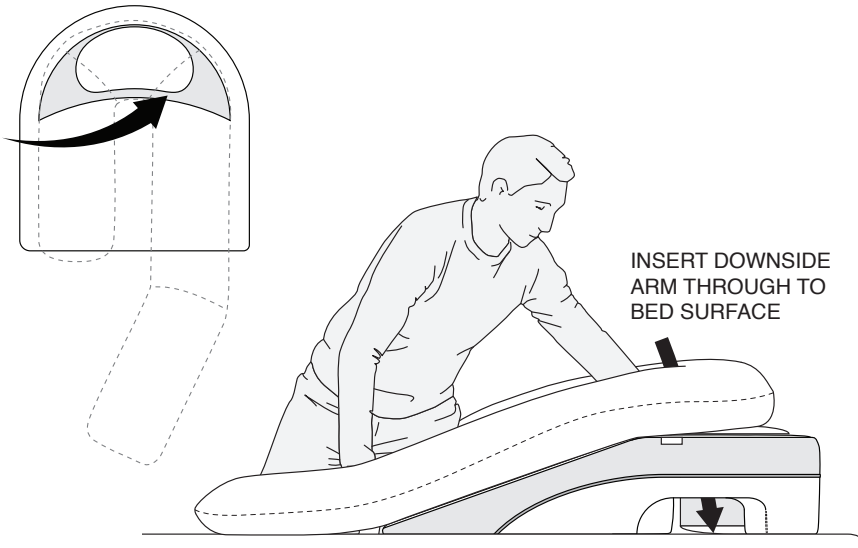

- 2** Lie down while allowing your elbow to descend and ultimately rest on the bed surface. Once your body has settled, your downside arm and shoulder should no longer be supporting your weight.

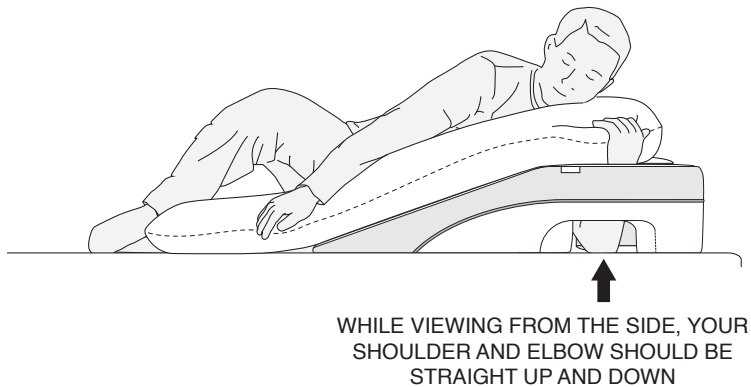

Care Instructions

- !** Follow label instructions for specific washing and drying recommendations for each component.

All outer covers are removable and machine washable. The undercovers should be wiped clean with a damp cloth only. The internal portions of the Insert Pillow and the Body Pillow are spot clean only. The foam inside the Incline Wedge cannot be machine washed or dried.

Questions and Feedback

To contact Amenity Health with questions or feedback regarding the use of MedCline, please call or email:



1-858-605-1747

support@medcline.com

Use Instructions and Recommendations

EXPERIMENT TO FIND WHAT WORKS BEST FOR YOU:

Please keep in mind that it is perfectly normal to take time to adjust to the new sleep position created by MedCline. To maximize comfort, feel free to try the Body Pillow with the long limb in front or behind you; with the Body Pillow between our knees or not; with your arm in different positions; or even with different head pillows of varying heights (instead of the Body Pillow). If you would like suggestions, give us a call at 858-605-1747. We offer our 100-night Guarantee to give ample time to find the ideal position that works best for you.

ACID REFLUX (GERD) RELIEF TIPS:

The length of time you need to use MedCline each night may vary. Most reflux episodes occur in the first half of the night, therefore you may only need to use MedCline for the first few hours of the night. Also, it is not necessary to stay in a single position during use. During the night, feel free to change arm positions, switch sides, or otherwise reposition yourself to maintain comfort.

If you suffer from Laryngopharyngeal Reflux (LPR) or “silent reflux”, you may need to use MedCline for an additional amount of time to feel complete relief. Typical LPR symptoms of chronic cough, sinusitis, hoarseness, etc. are resolved after a greater period of time.

LEFT vs. RIGHT-SIDE USE:

MedCline can be used on your left or right side. Those using MedCline for acid reflux (GERD) relief should start by sleeping on the left side. Clinical studies have shown that for most patients, reflux relief is best achieved by sleeping on the left side.

OTHER USES:

MedCline was thoroughly tested with GERD patients, however some additional uses may prove beneficial, depending on your individual circumstances. Please consult your physician, if you are unsure about MedCline use.

3

The Insert Pillow is designed to move within the cavity of the Incline Wedge. Move to add support where you need it.

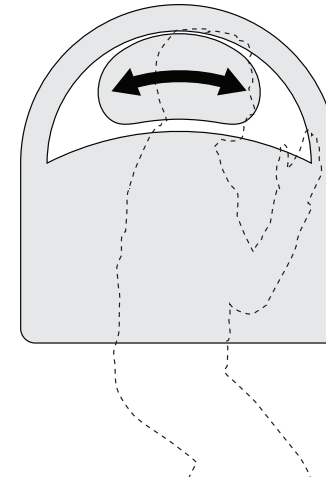

INSERT PILLOW IS DESIGNED TO MOVE WITHIN THE CAVITY

4

Ensure that your arm is straight down inside the pocket so there is no pressure on your armpit or underside of your downside arm. You may need to scoot up the incline to accomplish this.



SCOOT UP THE WEDGE TO RELIEVE ANY UNDERARM PRESSURE

5 The Body Pillow is adjustable and may need to be fluffed up or flattened out for optimal head and neck comfort. Try various positions until you are comfortable and able to relax.

NECK AND SHOULDER ARE TUCKED CLOSE TO BODY PILLOW, TO PROPERLY SUPPORT HEAD AND NECK.



KEEP HIPS AND KNEES BENT TO AVOID DISCOMFORT IN THE LOWER BACK

NOTE: The long limb of the Body Pillow can be used in front of you or behind you, in both the left-side down and right-side down positions.

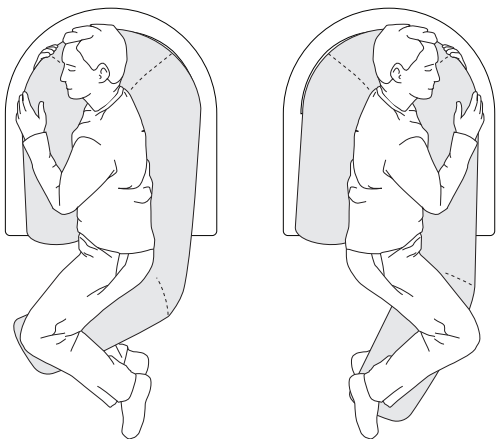

6 Find a comfortable position for your hands and arms using either position **a** or **b** shown below:

a This position is recommended, if you find yourself sliding down or if your hand falls asleep in position **b**.



b This position is recommended, if you have longer arms or otherwise feel restricted in position **a**.

