

# Other Genuine Big John Products



## BIG JOHN COMMUNE CHAIR

1,000 lb. capacity



## FOR EVERYONE'S PERSONAL HYGIENE

Very easy to install  
New T-connector installs  
directly to tank.



## BIG JOHN HYGIENIC SPRAYER

## BIG JOHN TOILET SUPPORTS

### REGULAR & SHORT SWIVEL

The secure solution for  
supporting wall mounted toilets...

➔ Protect yourself  
from liability, get  
the Big John  
Toilet Support

➔ Wall-Mounted  
Toilet Supports  
Increases capacity  
to 1,000 pounds.



The secure  
solution for  
supporting wall  
mounted toilets.



Top of Short  
Support Swivels

Height  
Adjustment  
From  
7.5" to 14"

Height  
Adjustment  
From  
5" to 7.5"

# The Big John Standard



Model#6W

19" wide from Side to Side

See Our  
Wall-Mounted  
Toilet Supports  
on the back

# Installation Instructions

MADE IN THE U.S.A.

Big John Products 8533 Canoga Ave. Suite D, Canoga Park, CA 91304  
TOLL FREE: 866-366-0669

ADA Compliant Registration Number 4.23 ADAAG

Meets or exceeds

ASME / ANSI Z124.5

CSA

IAPMO / UPC



**MADE IN THE U.S.A.**



[www.bigjohnproducts.com](http://www.bigjohnproducts.com)

# 11 Easy Step-by-Step Instructions for Installing the Big John **Standard** Toilet Seat

## Step 1



Insert screws into left & right hinge

## Step 2

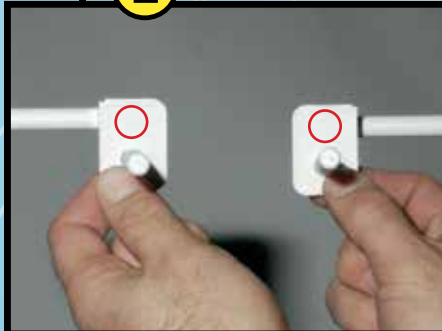

Hinges are marked right and left

## Step 3



For installation in the U.S. insert spacer on left & right hinge

## Step 4



Slide the rubber gasket over the plastic screw on both the left and right hinge

## Step 5



Insert Right Hinge\*

## Step 6



Mount on toilet and adjust so hinges are flat

## Step 7



Be sure to put on the nuts with the beveled side up

## Step 8



Finger tighten the nuts...make sure that the seat is mounted properly

## Step 9



Secure the seat using a screwdriver...  
**DO NOT OVERTIGHTEN**

## Step 10



Snap cover onto hinge to cover the screw head

## Step 11



Snap cover onto hinge to cover the screw head

\*Left / Right Hinges -  
Refers to the left and right mounting holes on the toilet when facing it.

